

10-Key RF Remote Controller

Model No.: KR1/KR2/KU4/KU8

1, 4, 8 zone dimming/10-key/Wireless remote 30m distance/CR2032 battery/Magnet stuck fix



KR1
1 Zone Dimming



KR2
1 Zone CCT



KU4
4 Zone Dimming



KU8
8 Zone Dimming

CE RoHS LVD RED

Features

- Apply to single color or dual color LED controller.
- Each remote can match one or more receiver.
- CR2032 battery powered.
- Operate with LED indicator light.
- Magnet on the back which can be easily stuck on back holder or any metal surfaces.

Technical Parameters

| Input and Output | |
|------------------|-------------------------|
| Output signal | RF(2.4GHz) |
| Working voltage | 3VDC(CR2032) |
| Working current | < 5mA |
| Standby current | < 2μA |
| Standby time | 2 years |
| Remote distance | 30m(Barrier-free space) |

| Environment | |
|-----------------------|-------------------|
| Operation temperature | Ta: -30°C ~ +55°C |
| IP rating | IP20 |

| Safety and EMC | |
|----------------------|---------------------|
| EMC standard (EMC) | EN301 489, EN 62479 |
| Safety standard(LVD) | EN60950 |
| Radio Equipment(RED) | EN300 328 |
| Certification | CE, EMC, LVD, RED |

| Warranty | |
|----------|---------|
| Warranty | 5 years |

| Weight | |
|--------------|---------|
| Net weight | 0.040kg |
| Gross weight | 0.064kg |

Mechanical Structures and Installations

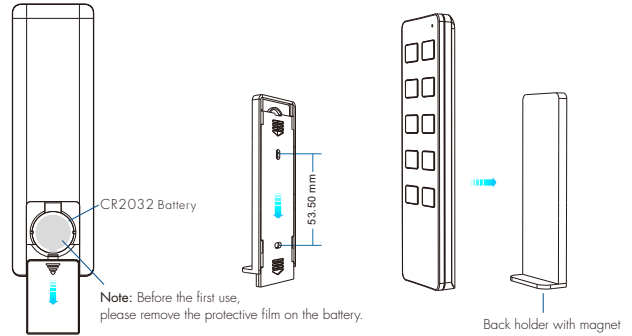
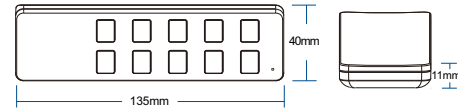

To fix the remote, three options are offered for selection:

- Option 1: stuck the remote on any metal surfaces directly.
 Option 2: fix the remote' back holder on the wall with two screws.
 Option 3: adhere the remote' back holder to the wall with pastar.

Match Remote Control (two match ways)

End user can choose the suitable match/delete ways. Two options are offered for selection:

Use the controller's Match key

Match:
 Short press match key, immediately press on/off key (single zone remote) or zone key (multiple zone remote) on the remote.
 The LED indicator fast flash a few times means match is successful.

Delete:
 Press and hold match key for 5s to delete all match,
 The LED indicator fast flash a few times means all matched remotes were deleted.

Use Power Restart

Match:
 Switch off the power, then switch on power again,
 immediately short press on/off key (single zone remote) or zone key (multiple zone remote) 3 times on the remote.
 The light blinks 3 times means match is successful.

Delete:
 Switch off the power, then switch on power again,
 immediately short press on/off key (single zone remote) or zone key (multiple zone remote) 5 times on the remote.
 The light blinks 5 times means all matched remotes were deleted.

Key function

• KR1 1 zone dimming remote

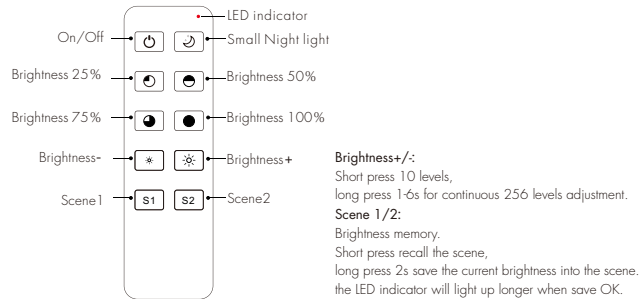

• KR2 1 zone CCT remote

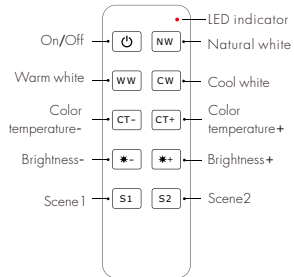

Color temperature+/-:
Short press 11 levels, long press 1-6s for continuous 256 levels adjustment.

Brightness+/-:
Short press 10 levels, long press 1-6s for continuous 256 levels adjustment.

Scene 1/2:
Short press recall the scene, long press 2s save the current color into the scene, the LED indicator will light up longer when save OK.

• KU4 4 zone dimming remote

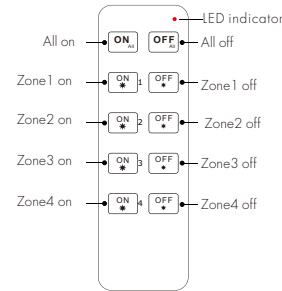

All on: Turn on all 4 zone light.

All off: Turn off all 4 zone light.

Zone 1-4 on:

Short press turn on zone light, long press 1-6s increase brightness continuously.

Zone 1-4 off:

Short press turn off zone light, long press 1-6s decrease brightness continuously.

• KU8 8 zone dimming remote

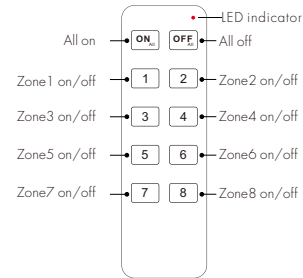

All on: Turn on all 8 zone light.

All off: Turn off all 8 zone light.

Zone 1-8 on/off:

Short press turn on/off zone light, long press 1-6s increase or decrease brightness continuously.

Safety information

1. Read all instructions carefully before you begin this installation.
2. When installing battery, pay attention to the battery positive and negative polarity. A long time without the remote control, remove the battery. When remote distance becomes smaller and insensitive, replace the battery.
3. If no response from the receiver, please re-match the remote.
4. Gently handle remote, beware of falling.
5. For indoor and dry location use only.